

## EXHIBITION

During the congress, an exhibition will be held.

All coffee breaks and the lunch will take place in the exhibition allowing attendees and exhibitors to ex-change in a friendly atmosphere.

## BOOTH

500 € TTC

- 2 entrances
- 1 table (without tablecloth)
- 2 chairs
- 1 kakemono (provided by the exhibitor)
- 2'// 2 slides on stage before the 1<sup>st</sup> coffee break

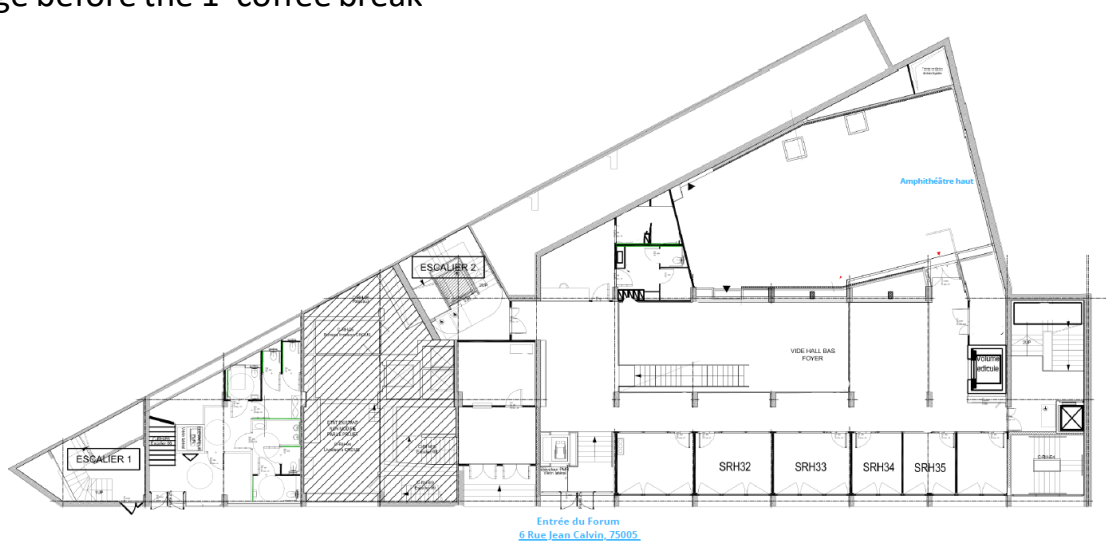
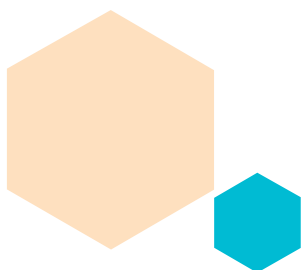

For more information



## CONTACT

Pauline Desportes - SFIP

[pauline.desportes@sfip-plastic.org](mailto:pauline.desportes@sfip-plastic.org)

Tel: + 33 (0)1 46 53 10 74

